

TOTALLY ENCLOSED FAN COOLED STANDARD MOTORS WITH SQUIRREL CAGE ROTORS

FOOT MOUNTING (B3 DESIGN)

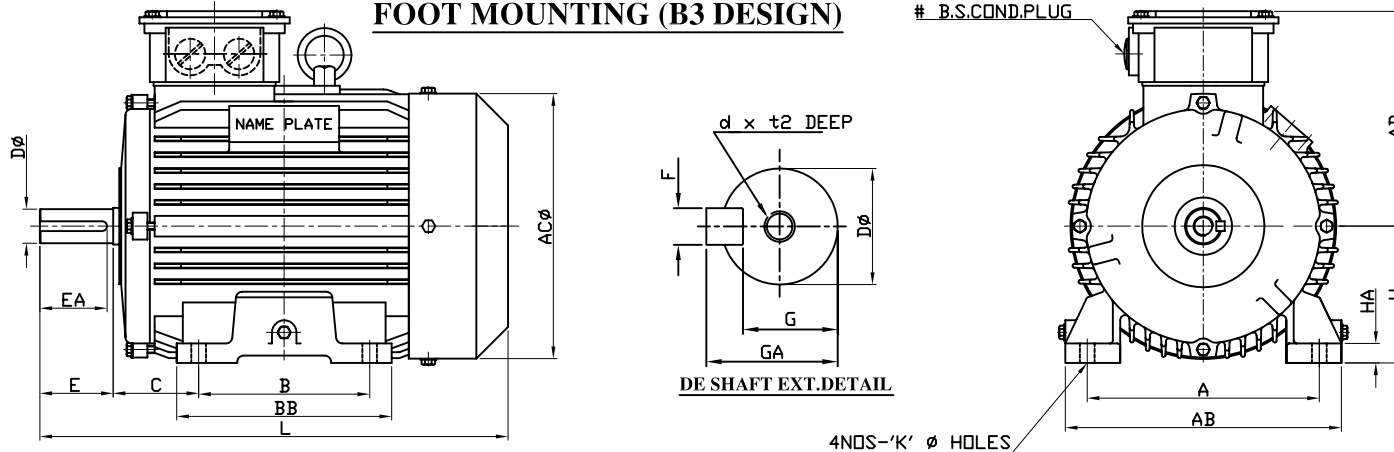

FRAME	A	B	C	D	d x t2	E	EA	F	G	GA	H	HA	K	AB	AC	AD	BB	L
B63AWC	100	80	40	11	M 5X12	23	17	4	8.5	12.5	63	8	7	118	120	95	96	205
B71AWC	112	90	45	14	M 5X12	30	25	5	11	16	71	9	7	133	140	110	110	255
B80AWC	125	100	50	19	M 5X12	40	35	6	15.5	21.5	80	11	10	152	160	100	125	290
B90S	140	100	56	24	M 5X12	50	45	8	20	27	90	13	10	170	178	130	125	310
B90L	140	125	56	24	M 5X12	50	45	8	20	27	90	13	10	170	178	130	150	335
B100L	160	140	63	28	M10X26	60	55	8	24	31	100	13	12	190	198	150	176	380
B112AWC	190	140	70	28	M10X26	60	55	8	24	31	112	12	12	220	218	170	176	395
B132S	216	140	89	38	M12X28	80	70	10	33	41	132	16	12	255	258	195	176	480
B132M	216	178	89	38	M12X28	80	70	10	33	41	132	16	12	255	258	195	214	518
B160M	254	210	108	42	M16X32	110	95	12	37	45	160	20	15	305	290	215	256	618
B160L	254	254	108	42	M16X32	110	95	12	37	45	160	20	15	305	290	215	300	662
B180M	279	241	121	48	M16X32	110	95	14	42.5	51.5	180	28	15	335	353	285	335	715
B180L	279	279	121	48	M16X32	110	95	14	42.5	51.5	180	28	15	335	353	285	335	715
B200M	318	267	133	55	M20X40	110	95	16	49	59	200	32	19	390	397	315	375	765
B200L	318	305	133	55	M20X40	110	95	16	49	59	200	32	19	390	397	315	375	765
B225S 2POLE	356	286	149	55	M20X40	110	95	16	49	59	225	35	19	430	430	340	385	845
B225S 4,6,8POLE	356	286	149	60	M20X40	140	125	18	53	64	225	35	19	430	430	340	385	875
B225M 2POLE	356	311	149	55	M20X40	110	95	16	49	59	225	35	19	430	430	340	385	845
B225M 4,6,8POLE	356	311	149	60	M20X40	140	125	18	53	64	225	35	19	430	430	340	385	875
B250M 2POLE	406	349	168	60	M20X40	140	125	18	53	64	250	38	24	486	485	365	430	935
B250M 4,6,8POLE	406	349	168	65	M20X40	140	125	18	58	69	250	38	24	486	485	365	430	935

NOTES:-

- 1) DIMENSIONS AS PER IS: 1231
- 2) DIMENSIONS d X t2 AS PER IS: 2540
- 3) LIFTING EYE BOLT WILL BE PROVIDED FOR FRAME SIZE B132 AND ABOVE UPTO FRAME SIZE B180
- 4) LIFTING EYE BOLTS 2 Nos. WILL BE PROVIDED FOR FRAME SIZE B200 TO B250 AT 45°
- 5) # 3/4" B.S. COND. UPTO 160 FRAME AND 1" B.S. COND. FOR 180, 2" B.S. COND. FOR 200 TO 250 FRAME
- 6) FOR 63 & 71 FRAME SHAFT WILL BE PROVIDED WITH CLOSE KEYWAY, 80 TO 250 FRAME SHAFT WILL BE PROVIDED WITH OPEN KEYWAY.

PROJECTION

GEN. TOLERANCES ON DIMS

1 PLACE DEC:- ±0.5mm
2 PLACE DEC:- ±0.13mm

MACHINED SURFACES SHOWN BY

▽ Rough Finish
▽▽ Ground Finish
▽▽▽ Chamfer 0.5x45°

IF IN DOUBT, ASK

ALL DIMENSIONS ARE IN mm

MATERIAL OF FRAME

63 TO 80/112-ALUMINIUM FRAME
90/100/132 TO 250-C.I.FRAME

DRN. CHD. PCP 09-01-2006

APPD. SMV 09-01-2006

SCALE N.T.S.

3 PHASE MOTOR
TEFC/B3

DIMENSION DRG.

SPARTAN ELECTRICALS
WAGLE ESTATE, THANE-400604

REV-01